



DETROIT[™]
DEMAND PERFORMANCE[™]

18SP694 – EPA07 DD Platform High Pressure Fuel Flange Service Kit (P/N: A4720785844)

KIT CONTENTS

Service kit P/N: A4720785844 contains all of the necessary parts to eliminate the emergency lubrication line on EPA07 DD Platform engines. In addition to installing the parts, the MCM must be reprogrammed for the engine to run properly with the new hardware.

KIT CONTENTS

Service kit P/N: A4720785844, shown in Table 1, contains all of the necessary parts to eliminate the emergency lubrication line on EPA07 DD Platform engines .

Part No.	Qty.	Description
A4720781144	1	M14 Plug
A4720781044	1	High Pressure Fuel Flange
A4710780280	1	High Pressure Fuel Flange Gasket
18SP694	1	Installation Instructions

Table 1 EPA07 DD Platform High Pressure Fuel Flange Service Kit Contents (P/N: A4720785844)

SERVICE PROCEDURE

Use the following procedure to eliminate the emergency lubrication line on the engine:

1. Steam clean the engine.
2. Drain the fuel system.
3. Remove and discard the emergency lubrication line from the fuel filter module and high pressure fuel flange.
4. Remove and discard the emergency lubrication line fitting (1) from the fuel filter module.

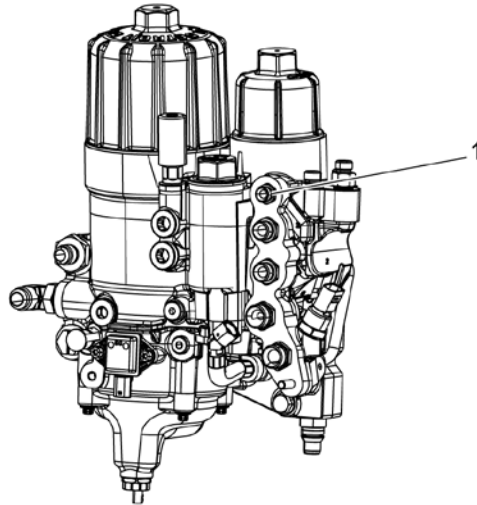

d470254

Figure 1 Emergency Lubrication Line Fitting Location

5. Remove the low pressure fuel lines from the high pressure fuel flange.
6. Remove the doser fuel supply line from the high pressure fuel flange.
7. Remove the needle return line from the high pressure fuel flange.
8. Remove the high pressure fuel flange from the high pressure fuel pump and discard the high pressure fuel flange and gasket.
9. Clean the high pressure fuel flange sealing surface on the high pressure fuel pump.
10. Install the new high pressure fuel flange with the new high pressure fuel flange gasket on to the high pressure fuel pump. Torque to 30 N·m (22 lb·ft).

NOTICE:

When installing fuel lines, the fuel line must be held to prevent twisting. Failure to hold the fuel line may result in internal damage to the fuel lines.

11. Install the needle return line on to the high pressure fuel flange. Torque to 25 N·m (18 lb·ft).
12. Install the doser fuel supply line on to the high pressure fuel flange. Torque to 25 N·m (18 lb·ft).
13. Install the low pressure fuel lines on to the high pressure fuel flange. Torque to 30 N·m (22 lb·ft).
14. Lubricate the M14 plug O-ring with a light coat of clean diesel fuel.
15. Install the M14 plug (1) on to the fuel filter module. Torque to 40 N·m (30 lb·ft).

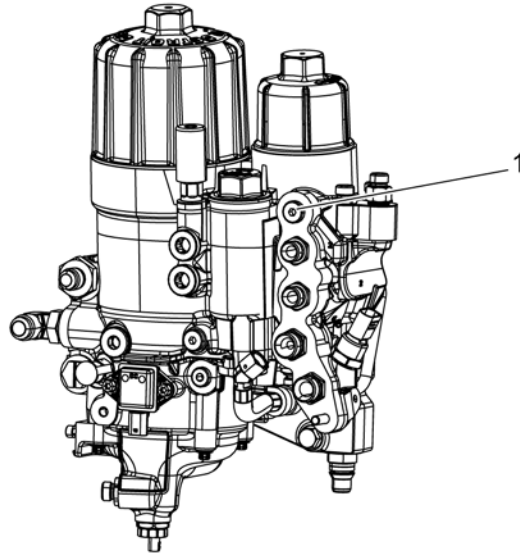

d470255

Figure 2 M14 Plug Installation Location

16. Reprogram the Motor Control Module (MCM) to software level V13.4 or higher.
17. Prime the fuel system.



13400 Outer Drive, West, Detroit, Michigan 48239-4001
Telephone: 313-592-5000
www.detroitdiesel.com

Specifications are subject to change without notice. Detroit Diesel Corporation is registered to ISO 9001:2008. Copyright © 2013 Detroit Diesel Corporation. All rights reserved. Detroit™ is a brand of Detroit Diesel Corporation, a Daimler company.

18SP694 1305 As technical advances continue, specifications will change. Printed in U.S.A.